

## TECHNICAL DATAS: ISINAC HANGING PANEL with or without fabric

### DESCRIPTION:

Absorbent Acoustic Panel by Alfa Sabine 1,00.  
Great Acoustic Absorption. Low wight <9kg/m<sup>3</sup>.

### USES:

Decrease the reverberation, echo and airborne noises.

Aerial acoustic improvement in medium and high frequencies.

### CHARACTERISTICS:

#### Foam:

With a density (ISO 845) of 9kg/m<sup>3</sup> +/- 16%.  
Compressive resistnace (ISO 3386/1): > 5kPa  
Traction resistance (ISO 1798): > 90 kPa  
Thermal conductivity: ≤ 0,035 W/mK  
Fire Classification (EN ISO 13051-1):

- B-S1,d0 thickness <25mm
- C-S2-D0 thickness >26mm

#### Color:

- Light grey or White without fabric
- With fabric 22 colors

#### Fabrics:

Trevira CS 100% polyester  
B-S1-D0 fire classification  
10 years guarantee from the manufacturer.

#### POSSIBLE SIZES:

On request any shape and thickness  
between the sizes:

- foam 2440.1220.500mm
- fabric de 1500mm width.

#### STANDARD SIZES:

More than 170 standard shapes and 4 different thickness.

Hanging installation.

#### TOLERANCES OF HOLES:

During the manufacture of the product, the inclusion of air (blowholes) frequently occurs. By dividing the plates, these blowouts become visible

Front and edges:      ∅ a 5mm: unlimited  
                                  ∅ 10-15mm: <10uds piece  
                                  ∅ 15-25mm: <2uds piece

Back: unlimited in quantity and size

#### DIMENSIONAL TOLERANCES:

During cutting there are dimensional mismatches of the material, the tolerances in length and width are

of +/- 3-5mm

### ABSORPTION COEFFICIENT:

Test made in TecNALIA, authorised in 46 countries..

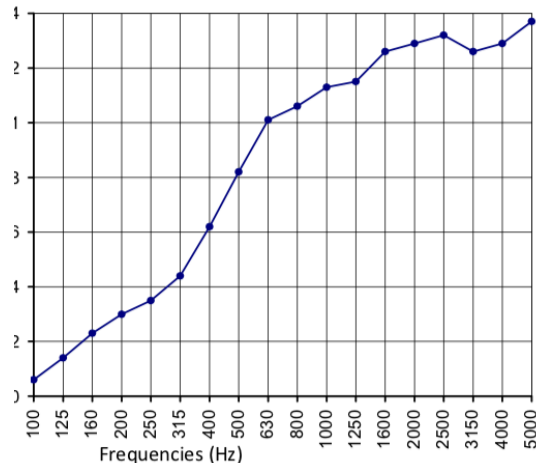

### INSTALACIÓN:

- Own foam anchoring hardware.
- To anchor to any type of surface.
- Carry out a correct layout place the Chrome trim (plug and screw are not supplied)
- Installation hardware consisting of a chrome trim on the ceiling, plus a 1m long cable plus a decorative carabiner to anchor it to the spring hardware that holds the foam.
- In ceilings.
- The panel can be installed vertically, horizontally and inclined.
- With cover of several colors.
- Quick-drying washable covers.
- The covers can be put and removed, in order to wash them or change the colors.

### CLEANING:

Fabric 100% polyester Trevira CS, wash cold.  
Some pieces can be ordered with a cover type fabric, these covers are removable and machine washable in cold water.  
Clean the foam with vaccun.

### COLORES:

## TECHNICAL DATAS: ISINAC HANGING PANEL with or without fabric

LUCIA CS



### HANGING HARDWARE:



### PHOTOS OF THE PANEL:



### FOAM ANCHOR HARDWARE:

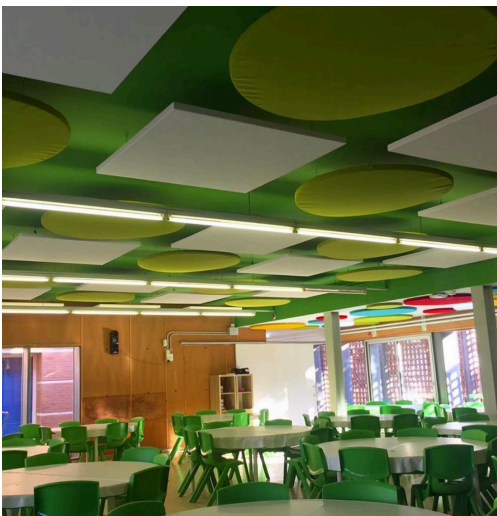
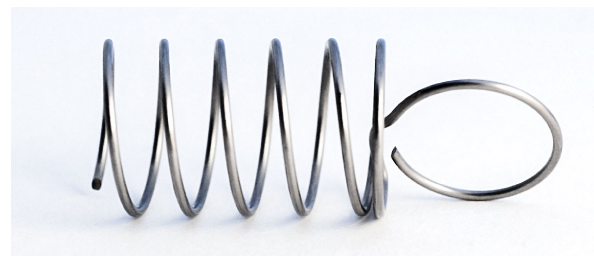

**AVISO LEGAL:** De acuerdo a lo establecido en la Ley Orgánica 15/1999, de 13 de diciembre, de Protección de Datos de Carácter Personal, le informamos de que los datos personales que nos facilite, serán incorporados a un fichero titularidad de ISINAC ACOUSTIC WORLD SL, con domicilio en C/ LÓPEZ DE NEIRA, Nº3 - 3ª PLANTA, OFICINA 301, 36203 - VIGO - PONTEVEDRA, que cumple con las medidas de seguridad exigidas en el Real Decreto 1720/2007 de 21 de diciembre, y cuya finalidad es la gestión, control y seguimiento de las relaciones comerciales con los clientes. Como cliente de ISINAC ACOUSTIC WORLD SL podrá ejercitar los derechos de acceso, rectificación, cancelación y oposición, comunicándolo por escrito a la dirección arriba indicada.

**AVISO LEGAL:** La utilización, copia o divulgación por cualquier medio del presente documento, sin autorización del remitente, está prohibida y podrá dar lugar al ejercicio de las acciones legales oportunas